

## Village News Sheet

Delivered Free  
Circulation 1,800

What's on page 3

Sheltered Housing  
Questionnaire

New competition page 7

Spring Issue - April 1997

Issue 27

# New Local Policeman For Milton

Pc Philip Shulver will be taking over from Pc Ian Parton as your Community Beat Officer as from the end of March 97. He has been out in the Rural Sector for about a year and is looking forward to hearing your views and meeting as many people as he can.

If you have any queries Pc. Shulver asks that you contact him by phoning Histon 232222 and if he is not there, to leave a message and he will get back to you as soon as possible.



Pc. Philip Shulver

Milton Parish Council  
**Annual Parish Meeting**  
Monday 28th April  
8.00pm  
Milton Community Centre

Presentation on  
Sheltered Housing  
in the Village  
\*Questionnaire Enclosed\*

## Impington Village College Mourns Sad Loss of Warden

Dr. Sylvia West, Warden of Impington Village College, Cambridge, who died suddenly after a short illness, on February 13th at the tragically early age of 51 was that rare combination of noted philosopher and successful practitioner. Her funeral was held at the Cambridge Crematorium at 4.30pm on 21st of Feb. and attended by friends, staff and governors of the College.

During her time at IVC, Dr. West, in partnership with the Local Education Authority (LEA), introduced a workplace nursery, negotiated the introduction of a special needs department for the physically disabled and supported the efforts which raised £500,000 to fund a new indoor swimming pool.

Sylvia West had been the Warden at Impington Village College for eleven years and will be sadly missed.

At this sad time governors, with the support of the LEA, have had to go forward and advertise the position of Warden in the hope that an appointment can be made for September.

In the meantime Angela Pereira is acting head and is very kindly being supported by Cottenham Village College Head, Tony Cooper.

JC

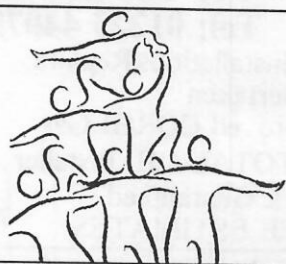

## Supporting the community



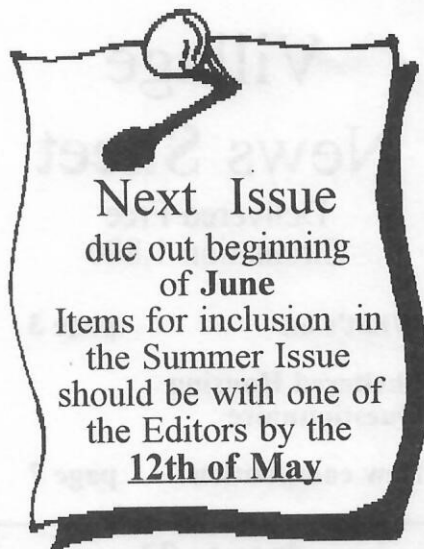

## Next Issue

due out beginning  
of June

Items for inclusion in  
the Summer Issue  
should be with one of  
the Editors by the  
**12th of May**

## Meals on Wheels

Organiser in Milton needed to coordinate group of voluntary helpers in delivering meals to the housebound in the village.

Tel. WRVS Offices 350294  
or Pat Fletcher 860425

## Milton Music School

### Open Day

Saturday 14th June 10.00-12.00  
At Milton Primary School

Are you aged 7-77+? Do you play an instrument at all? Come and try the orchestra from 10.00-11.00.

Are you aged 3-6? A creative music class will run from September. Come and try it from 11.00-11.30.

Do you play the recorder? An all age recorder group is available to try from 11.30-12.00. Again come and have a go.

All these activities are free to visitors on the 14th June. A range of instrumental lessons are also available (some before September).

If you are interested in beginning a new instrument The Music Gallery from King's Hedges Road will be at the Music School from 11.00 to 12.00 with a range of instruments for you to try.

If you would like more details about the music school please ring:

Peter Rice on Cambridge 863127.

## Children raise money for Leprosy Appeal



Polly Maltby and Michelle Medd (pictured above) both aged 10 of Milton Primary School, recently raised £161.00, with a bring and buy stall and coffee morning, at Marshalls Toyota Showroom, in aid of the Blue Peter Leprosy Appeal.

## The Children's Hospice for the Eastern Region - Gala Day

Gala Day is to be held in the grounds of the children's hospice from 11 - 4 on Saturday 17 May 1997.

This year the theme is 'Space' and we will have all sorts of fun attractions for everyone. Including Bouncy Castle - Gladiator Games - Puppet Show - Face Painting - Brass Band - Aerobic Display - Irish Line Dancing and many games and stalls for everyone to enjoy.

New this year is our Art Competition for Children. Following the space theme children are invited to enter a drawing or painting in our competition with prizes for each category of under 5, 5 - 8 and 8 - 11. Entry is 20p and can be made on the day in the Church Hall.

We are also appealing for any unwanted gift items - toiletries - bottles (full!) - cakes and plants that people wish to donate. These are accepted at the hospice at any time during office hours.

## To: Residents of Pearson Close and Pearson Court.

Thank you for supporting my house-to-house collection on behalf of the Imperial Cancer Research Fund. I have been informed by the Fund's National Manager of Collections that to date of writing (end of February) £250,000 has been raised from the Appeal and receipt of more donations are anticipated. The Fund Manager appreciates our help to win the fight against cancer.

Ann Merry  
9 Pearson Close

## The Misuse Of The Apostrophe

Our anonymous correspondents are still finding the odd misplaced apostrophe in the Village View. But frankly I'm too old in the tooth to worry any more about it. For me, life's too short, but at the same time the Editors are delighted to know that there are at least two persons who read the V.V. from cover to cover. May we say in conclusion that the Editors admire and respect our correspondents dedication to their cause. FINIS.

Harry Captain

## PAINTING DECORATING GLAZING

Mobile  
0860 453533  
(local resident)



## Schwarzkopf

For lasting curls  
style and volume with

### 'Natural Styling'

at

Bettys Unisex Hairdressers  
Tel: 420526

## FLORIES

### BRIDAL FLOWERS

Fresh, dried & silk bouquets etc.

Let me design your wedding personally

Fully qualified florist for 26 years  
Phone Daryl 862093 or 01353 688303

## M J POTTS HEATING & PLUMBING SERVICES

300 The Rowans  
Tel: 01223 440795

All Installations/Repairs  
undertaken

Approved CORGI Gas  
& TOTAL OIL Installer  
Work Guaranteed  
FREE ESTIMATES

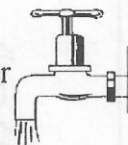



## Milton Country Park

All events/activities start from the Visitor Centre. Please wear suitable clothing.

A charge is made for the children's WATCH activities.

For further information contact:-

The Ranger -

Malcolm Busby on  
(01223) 440196

### April

Saturday 5th  
WATCH activity  
Spring Walk  
2.00pm - 3.30pm

Sunday 20th  
Work Party  
Wetland Restoration  
9.00am - 12.00noon

Sunday 27th  
Family Bird Walk  
2.00pm

### May

Saturday 3rd  
WATCH  
Web of Life  
2.00pm - 3.30pm

Sunday 4th  
Dawn Chorus  
5.00am start  
£4.00 - includes  
breakfast  
BOOKING  
ESSENTIAL

Monday 5th  
Animal Day  
From 1.00pm  
onwards

Royal British  
Legion/Royal Air Force  
Association  
MAY 10th

## Springtime Dance/Buffer

Waterbeach Primary  
School

Time 8.00pm to 11.30pm

Tickets £7.00

Contact: 32 Coles  
Road, Milton.

MILTON OUTDOOR  
BOWLS CLUB

## JUMBLE SALE

Milton Outdoor Bowls  
Club Pavilion

Saturday 19th April at

2.00 p.m.

Admission 20p

Thank you for your  
support

Milton Day Care Centre  
Friday 18th April 97  
11 am. - 12 noon

## COFFEE MORNING

and

## BRING & BUY

in the Community Centre

Everyone welcome

Proceeds towards our  
Summer Outing

MILTON PRE-SCHOOL  
(A Registered Charity)

## NEARLY NEW CLOTHES SALE

WEDNESDAY 16th APRIL

Small Hall

Milton Community Centre

9.30 - 12.00

To leave clothes before the day please  
phone Anne 441328, Linda 560553 or  
Caroline 441376 or bring them to the small  
hall on the morning of the sale.

Clothes should have the name and phone  
number of the seller 75% of the sale price to  
the seller, 25% to Pre-School funds.

School Uniform section/boys and girls  
clothes 3-10 years.

ALL SAINT'S CHURCH MILTON  
We will run another 10-week

## Alpha Course

for those wanting to find out more about  
Christianity or do a "refresher" course.

Starting with an ALPHA SUPPER - with  
an opportunity to find out more

on Fri. 18th April at 7.30 pm

ALPHA COURSE runs from Wed. 30th

Apr. - Wed. 9th July from 8-10 pm.

Contact THE CHURCH OFFICE 441007  
for more details or to book.

Date for your Diary

## Milton Fayre Weekend

Family Disco - Saturday 12th July

Children FREE 16 and over £1 only

Village Fayre - Sunday 13th July

MILTON SCHOOL ASSOCIATION  
A registered charity (charity number 1035659)

## LADIES FASHION SHOW & CLOTHES SALE

Featuring clothes manufactured by the factories  
that supply the leading chainstores

Clothes sold by

'The Clothes Line' Hertford  
(A factory outlet shop)

THURSDAY 24th APRIL 1997

Doors open at 7.30 pm

Show starts 8.00 pm

MAIN HALL

MILTON PRIMARY SCHOOL  
MILTON

Entrance Ticket £2.50

Including glass of wine

'The Clothes Line' state that they carry a good selection  
of Blazers, Jackets, Blouses, Skirts, Trousers,  
Leggings, Bodies, Knitwear & Underwear.

PLEASE NOTE THAT

All clothes must be purchased on the night

'The Clothes Line' do not take orders

All transactions involving the purchase of clothes will  
be between the purchaser and 'The Clothes Line'

'The Clothes Line' accept Access, Visa, Cheques with  
bankers cards and cash.

For further information/tickets, please contact either

Claire Vickery (01223) 860900 or

Bob Pain (01223) 514332

Milton Pre-school

## call eyes down for a full house

from 8-9.30 pm

Wednesday, 11th June

at Community Centre Annexe

Come and enjoy the fun

Call Frances for a lift on 573752

 Violin  
and  
Piano  
Tuition

Please contact:  
Fiona O'Shea, B.Ed Hons  
Tel. 440548 (Local resident)

 MILTON  
GAS  
SERVICES

Eddie Kikas  
29 Landbeach Road, Milton  
Tel/Fax: (01223) 861810  
Mobile: 0831 228181

 Corgi Registration  
Number 161938

Servicing, Installation & Repairs to  
all Gas Boilers, Fires, Cookers,  
Central Heating Systems etc.

Want a working plan  
for your garden...  
or just some ideas?

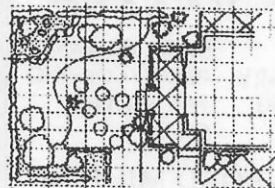

Contact Roger Clark  
on (01223) 870904  
for a free consultation

Sunday 13th July 1997

12.30pm - 5.00pm.

This year's theme is "Nursery Rhymes"

Please return this Booking form to Chris Hallworth, 12 Faulkner Close,  
[off the Sycamores] Milton, Cambridge. CB4 6EF -> **By 29th June.**

**£5 per pitch. Cheques payable to Milton Village Fayre.**

Please book the following on behalf of .....  
Number of stalls required @ 3.6m wide .....  
Type of stall/activity, whatever? .....  
Tent/Caravan to be used [state which] .....  
Do you require a trestle table? YES/NO ..... [You are requested  
to provide your own chairs]

Any special requirements? i.e. electricity .....

Signed ..... Please print name .....  
Address .....  
Tel. No. ..... Amount enclosed £ .....  
Name & Tel. No. OF VOLUNTEER FOR CLEARING GROUND AFTER  
FAYRE .....

## Just Thinking Of What Was

I was trying to imagine what children would do these days without computers and television, which makes me think about how we got through with what seems like next to nothing. "Here we go again" I can hear some of you saying, "We've heard it all before". We lived on a farm, no telly, no radio, no phone, no water from taps, water was carried in buckets from village pumps etc., that made you careful with water I can tell you.

Anyway what did we fill our time with, well we had a lovely life on the farm although at the time we didn't think so. I used to rush home from school to write or draw in a penny exercise book my Mum had bought us, in the evenings my Dad used to play Ludo with us and cards, the room was warmed up with the old fashioned blackleaded cooking range and lighting was from a lovely old paraffin lamp which helped to heat the room, I can see that old lamp now in my mind's eye. Life was hard but we hadn't television with adverts on to make us want what we couldn't afford, so we were content with our lot. If you like this story I will write another next issue, if nobody says anything then I will shut up.

Mary Georgena Burling  
- that was.

## Calling All Gardeners

With spring here and summer just around the corner many of you will be getting back into your gardens and wondering just how you should tackle all those jobs that have built up over the winter months.

Here at Cambridgeshire College of Agriculture and Horticulture, in Milton, we have been propagating bedding plants, trimming hedges and pruning shrubs.

At this college you will find a range of courses perfectly suited to the keen amateur gardener and covering a wide variety of topics from pruning shrubs and taking fuchsia cuttings to re-designing the whole garden. These courses vary in length from just two hours in total to one day a week over thirty weeks.

If you are interested in improving your "green fingers" then phone the college on Cambridge 860701 and ask for further details or talk to me.

Kate Ross.

50th Cambridge (Milton & Landbeach) Scouts

## Marquee hire

Marquee size 20 feet by 40 feet  
£140.00 for the first two nights, plus £15.00 for each  
additional night

(Price includes delivery, erection & dismantling)  
Telephone Bob on (01223) 514332

## MILTON POST OFFICE

CARDS SHOE REPAIRS  
CONFECTIONARY PHOTO COPYING  
DRY CLEANING FAX SERVICE  
STATIONERY GIFTS

2 COLES ROAD MILTON

Open: Mon - Fri 9.00am. to 5.30pm.  
Saturday 9.00am. to 1.00pm.

Painter & Decorator  
Interior & Exterior  
High Class Decorating  
Free Estimates

R.P. Kent

Tel. 01223

860995



Eric Franklin trading as  
**Pete's Quality  
Meats**

1a Arbury Road, Cambridge  
Tel. 01223 352853

Suppliers of first class pork,  
lamb, beef, poultry and game

**HIGH WELFARE AND  
FREE RANGE PRODUCTS A  
SPECIALITY**

**FREE** delivery in Milton  
Hand made sausages and burgers

B-B-Q packs, freezer packs,  
mixed grills made to order

**SPECIAL OFFERS AVAILABLE**

Tel: Eric 01223 352853

### Notice

Milton Village View is unable to check or verify the warranties, authenticity of or representations made by their advertisers and must therefore exclude liability howsoever arising from any advertisements in this newspaper. Nor do any statements necessarily accord with the opinions or beliefs of the Editors, Milton Parish Council or Milton Village View.

## Women's Institute

At our February meeting we had Oliver Cromwell and his companion, both in the outfits of that era, he really looked and acted the part. I am sure I shall look at the two models that stand outside Oliver Cromwell's house at Ely in a different light now.

The March meeting will be our A.G.M. when we usually enjoy a cheese and wine evening.

The month's competitions are varied, some appeal to members more than others, as do the speakers; we are always on the look out for different ideas in this area. We welcome new members and do try to make them feel at home.

Mary Daniels

### What's On

We hope you find this a useful reference. Thank you to all our delivery people for delivering this.

Jim Daniels & Jane Coston

**MILTON  
WINDOWS**

**Quality costs no more**

PVCu windows, doors, cladding &  
conservatories

Telephone 01223 440376



## **Sheltered Housing in Milton**

- There is a proposal to build self contained rented sheltered accommodation, which would be supported by a warden living on site.
- The scheme, of about 25 units, would be for elderly people, from Milton and the surrounding area.
- Milton is the only large village in South Cambridgeshire without sheltered housing.
- At present people in Milton requiring support in their old age have to move away from the village.

Over the years serious consideration has been given to building sheltered housing on sites at Fen Road; Milton Hall; Butt Lane; The Rowans and The Sycamores. The viability of these sites has been explored with South Cambridgeshire District Council Planners, but for various reasons they have been discounted. On 5th December 1994 the Parish Council agreed to ask South Cambs. District Council to investigate the use of part of Coles Road Recreation Ground adjacent to the hardcourts. Although the site has a number of advantages, there are some disadvantages to be resolved before a scheme can be approved.

- If the scheme is to go ahead it is important to know your opinion.
- Therefore we would be grateful if you would answer the following questions:

1. Do you believe there is a need for sheltered housing? YES NO
2. Would you personally be interested in moving to such a scheme? YES NO
3. Do you know of anyone else who might be interested in living in sheltered housing in Milton? YES NO
4. Do you support the use of part of the Recreation Ground for the scheme? YES NO

(Please delete YES or NO above)

Please add any other comments on the back of this sheet, thank you.

- Please return your answers by 21st April 1997 to the Community Centre, the Post Office in Coles Road or the Clerk to Milton Parish Council, 84 Coles Road Milton.

**THE RESPONSES AND FURTHER DETAILS OF THE SCHEME WILL BE DISCUSSED AT THE ANNUAL PARISH MEETING ON MONDAY 28TH APRIL 1997 AT 8.00pm AT MILTON COMMUNITY CENTRE WHERE WE WOULD WELCOME YOUR ATTENDANCE AND VIEWS.**

*Printed and published by Milton Parish Council*

## Friends Of Milton Country Park

First of all, a big thank you to everybody who helped the wildlife in the Park during the 'freeze up' at the beginning of the year. The water fowl especially enjoyed a large amount of donated food, not least from farmer Robin CHAPMAN with his generous donation of potatoes.

Now as I write, Spring has arrived (I think). Anyway, there are snowdrops in the Park and the birds appear to be pairing up and deciding where to start building nests for the coming year.

Speaking of nests, the 'Friends' took part in the British Trust for Ornithology campaign - 'Britain Needs More Holes' - the first of what is hoped to be an annual event. This was advertised as National Nest Box Week, running from 14th - 21st February. We chose Sunday the 16th for our nest box making day. After gloriously sunny days on the Friday and Saturday, Sunday started dull and by the time the event started 12.00 noon, it started to drizzle.

All our materials were purchased at a very competitive price from Travis Perkins, and U.K. Plant Hire lent us a circular saw to cut the timber to the correct lengths for the 'kits' before the day. Our grateful thanks to both firms concerned. Twenty four families came into our 'workshop' during the afternoon and assembled 'tit' and 'open' boxes. Most were taken home, but a few left for erection in the Park, for which we thank those concerned very much.

If you were not able to attend, we still have boxes for sale in the Centre, either in kit form or ready made. The cost in either case is £5.00, £2.00 of which will be sent to the B.T.O.

Just a reminder or two. Firstly the 'Friends' have a range of memorabilia for sale in the Visitor Centre. We also sell bird food at very competitive prices. If you feed the birds in your garden and are unable to get to the Park, I would be pleased to supply, cash on delivery, anywhere in Milton. Just give me a ring on Cambridge 515750.

Secondly, watch out for the date of the Sensory Garden opening. It is hoped that it will be towards the end of May, and notices will be erected in the Park and around the village.

*Tim Siggs*

'The Friends of Milton Country Park'

## Ken Green Retires after 25 Years

At a recent joint meeting of the Parish Council and the Community Centre Management Committee, the Chairman, Bob Waters on behalf of the group presented Ken Green with an electric drill and thanked him for all his hard work over the years.

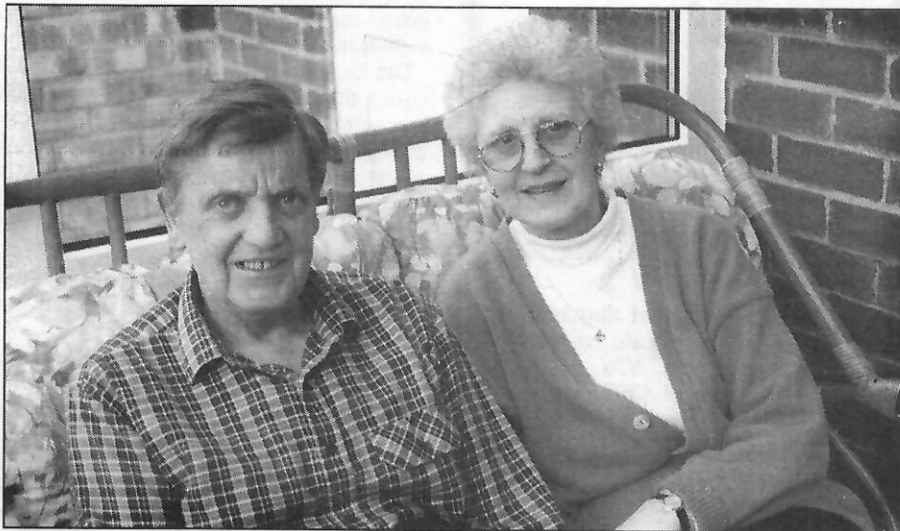

Ken and Joy Green

## MILTON'S OWN TAXI SERVICE

### MILTON CARS

441616

MILTON TO GRAFTON CENTRE	£4.00
MILTON TO CAMBRIDGE RAILWAY	£6.00
MILTON TO ADDENBROOKES	£7.00

## Mums And Under 1's

'Baby Group' is the best opportunity for new mums to get together and have a chat over a cup of tea or coffee (and we don't only talk about babies!) while the babies are able to play together, enabling them to learn how to mix with other children from a young age and gain confidence with different things such as tunnels and push along toys they may not have at home. Most villages have 'toddler groups', Milton is one of the only villages to have their own baby club - let's make the most of it!

Why not come and join us one Wednesday afternoon? We meet at the Church Hall between 2.00 and 4.00 p.m.

## Parent And Toddler Group

The Parent and Toddler Group at Milton Church Hall is a voluntarily run group as an outreach from the Church and allows parents, childminders, nannies etc. to mix and socialize with other members of the community and enjoy time out from their daily routine. It also aids social development of the children as child interaction plays a big part of the toddler group.

It runs on Mondays, Wednesdays and Fridays from 10.00 a.m. to 11.45 a.m. with refreshments at 10.35 a.m. serving tea, coffee and biscuits for adults and juice and biscuits for the children.

The group allows toddlers up to the age of 3 years and a charge of 50p per session is required for the upkeep and renewal of toys and payment for refreshments. The group also has general safety rules regarding the kitchen area and each carer is asked to sign in after paying in case of fire.

At 11.30 a.m. everyone helps to clear toys away and then we sit together for singing until 11.45 a.m which brings the session to a close.

Any more information required please contact:

Mrs. Sue Nunn, 75 Coles Road, Milton. Tel. 01223 861747

## M.J. BLACK

Carpentry & Joinery  
Fitted Kitchen Specialists  
complete service from  
Planning to Installation

Tel. (01223) 277772

Mobile 0831 626398

## R B

Electrical

Your Milton  
Domestic and  
Industrial Specialists

Tel. 861869

+++++	<b>Karen's Hair Studio</b>	+++++
+	1a Coles Road, Milton	+
+	Wednesdays	+
+	- Senior Citizens Day - 20% reduction	+
+	<b>Opening hours</b>	+
+	Tuesday 9am-5.30 (Closed Mondays)	+
+	Wednesday / Thursday 9am-6.00	+
+	Friday 9am-7.00 Saturday 9am-5.00	+
+	<b>Tel:(01223) 440198</b>	+
+	<b>Easy Parking</b>	+
+++++		+++++



## Kids R Us

Milton Community Centre

**Quality playcare**  
for children aged 4 - 12 years

**After School Club**

3.15 - 6.00pm (Term time)

**Holiday Club**

8.00am - 6.00pm (School Holidays)

Tel: Anne Cunningham

(01223) 503646

for further  
information and  
registration forms.



## Professional C.V.'s

Experienced personnel manager with  
knowledge of corporate recruitment  
available to prepare C.V.'s.

Contact Ms. Strobel 440329

## HOME-START

Cambridge & District

### WE ARE MOVING!!!

As from Monday 10th February 1997

the Home-Start office will be at:-

Barnwell Priory Community Wing

Priory School Site

Galfrid Road

Cambridge

CB5 8ND

The telephone number will be

Cambridge (01223) 210202



DIAMOND

LITE

DISCO

PARTIES  
WEDDINGS  
PRIVATE  
FUNCTIONS

Andy of Milton  
TEL. 440432

## Volunteer Sitters Needed

The 'Good Night' Service is a voluntary organisation which offers a sitting service to families who have a child with a physical and/or learning disability aged from birth to 19 years old. The Service aims to recruit volunteers, aged 16 or over, and match them with families in their own vicinity. On-going support and training is available to volunteers and expenses are reimbursed.

The Service was conceived in 1992 and covers the cities of Cambridge and Ely and the surrounding rural areas. There are currently over 50 families matched to volunteers and many other families who would welcome the opportunity to use the Service. Clearly, 'Good Night' is a very valuable resource for parents, enabling them to have a break from caring secure in the knowledge that their child is being well cared for.

In order for 'Good Night' to extend the Service to more families it is necessary to recruit more volunteers. No experience is necessary, merely a caring and sensitive attitude towards young people with special needs. If you would like to support this much needed service and would be able to offer at least one evening per month to a family, please contact:

Annie Saunders on 01223 318037.

## Minutes of 50 Years Ago

Parish Council Minutes, 25th Feb 1937

A discussion on Village Colleges took place and opinion was definitely against them. It was resolved that a halt should be called in the building of Village Colleges to see if those already built justify their expenditure. It was recommended that, if a College is built, it should be at Cottenham rather than Impington because in the latter case, Milton children would be forced to cycle the arduous journey to Impington, a very cruel procedure in the wind, rain and fog, whilst the Cottenham site was far enough away for the Education Committee to have to provide buses.

## MILTON BABY CLINICS

Surgery, Coles Road -

Monday 2-4 pm.

Community Centre, Coles Road -

1st Saturday in month 9.30-11.30 am

Church Hall, Church Lane -

3rd Wednesday in month 2-3.30 pm

No appointment is necessary.

Health Visitor Clare Capelin is available for advice, information and support on all aspects of your baby's or pre-school child's health, development and behaviour.

Further information contact:-

Clare on 420028.

Apologies for any inconvenience caused by the recent changes.

## Put a spring back into your step with the help of BUPA Cambridge Lea Hospital's hip and knee unit

The Cambridge hip and knee unit at BUPA Cambridge Lea Hospital is one of the first of its kind in the UK.

Designed to encompass all aspects of hip and knee surgery from the very young to the elderly, it has its own dedicated team of physiotherapists, nursing, theatre and out-patient staff all of whom are trained in the latest techniques for the care of patients undergoing hip and knee surgery. All medical staff lecture extensively on this aspect of orthopaedic surgery and a number have made contributions to medical publications in this field.

Surgery undertaken at the Cambridge hip and knee unit includes hip and knee replacement, "key hole" surgery, sports injuries and treatment for cartilage and ligament problems.

BUPA Cambridge Lea Hospital is a 49 bed independent hospital which is open to everybody not just BUPA members.

Staff will be delighted to show readers around our hip and knee unit or to send further information. Please telephone 01223 237474 for further details or to arrange a visit.

## YOUR NHS - FIND OUT WHAT'S GOING ON

Cambridge and Huntingdon Health Authority invite you to our Board Meetings held in public.

How your money is spent. What we do and how we do it.

Wed. 2 July 1997 St. Neots

Public Meeting 2.30pm

Wed. 24 Sept 1997 Conference Room, Fulbourn Hospital

Public Meeting 2.30pm

Wed. 22 Oct 1997 St. Ives

Public Meeting 2.30pm

Call Carol or Diana for more information 01223 218742

We try hard not to be secretive, evasive, or unapproachable. So please, come along and hear our plans.

## Lizzie's Workout

Milton Primary School

Monday 6.45 pm - 7.30 pm BodyBlitz (Floorwork Only)

7.30 pm - 8.30 pm Fat Burning Step

Wednesday 7.30 pm - 8.30 pm Fat Burning Step

Tel. Liz Ward (01223) 512818

## Clean Quality Workmanship from Planning to Completion.

FREE ESTIMATES & ADVICE



BUILDING  
CONTRACTOR

86 Butt Lane  
Milton

- New Houses
- Extensions
- Renovations
- Conservatories
- Loft Conversions
- UPVC Windows & Doors

TELEPHONE: 01223 440126



## LEGS, BUMS AND TUMS

Milton Community Centre Annexe

Thursday: 7.00 - 8.00 pm

£2.50 per class

Please bring a mat/towel and drink with you

Tel: Julie Durrant (01223) 441036



## MASQUERADE

Hair & Beauty Salon

6 High Street, Milton, Cambs.

Tel. (01223) 863636

For all hair & beauty treatments

## HOWARDS WAY

- \* Your local Instructor
- \* Excellent Pass Rate
- \* Free Pick Up
- \* Novice to Test
- \* Extensive Motorway Tuition Available
- \* Discounts Available

Tel. (01223) 862501  
(0589) 218045

DOT.ADL\CAADI.DIA.

193 The Rowans, Milton, Cambridge.

## Milton Toy Library

Where: MILTON COMMUNITY CENTRE, COLES ROAD  
When: 1st and 3rd THURSDAY OF EVERY MONTH  
How Much: £1.00 per annum membership  
TOY HIRE FROM 40p  
Contact: Sue Smith Tel: 862864

### How does it work?

The library is run by a small committee and by its members who can, if they so wish, go on a rota to help out at sessions by hiring out toys or making refreshments. Members might also like to help with fund-raising. But it's really up to you. You can:-

- Pop in to hire and return toys
- As above but stay for coffee and a chat while the children play with all the toys
- Get really involved by going on the rota, helping with fund-raising or even joining the committee!!

It's all informal, friendly and great fun!!

WHAT HAVE WE GOT? Toys from 0 - 5 years, indoor and outdoor.

## Dear fellow villagers

Long, long ago in your youth do you remember finding an old pram chassis with its wheels on, some wood or a soap box, a length of rope, hammer and nails and with some pals you built the fastest racing machine in the world. The years pass and the children grow up but you have kept that old pram in the loft, just in case.

Well, if you are certain that there aren't going to be any little surprises how about donating that **old rolling pram chassis to your Village Scout Group?**

The Cubs and Scouts have built soap boxes, go-karts, whatever you used to call them, in recent years but we do get through quite a few axles and wheels! So if you could spare that old rolling pram chassis I will be happy to call round to collect it if you will be good enough to give me a ring on 01223 441499.

Yours faithfully,

Chris Hallworth, Scout Group Secretary



## MY BOAT

My boat is turned up at  
both ends,  
All storms it encounters  
it weathers  
On its body you'll find not  
a board,  
But covered all over with  
feathers.  
We daily re-load it with  
rice.

船天渾一隻  
底大身要  
無要及  
縫裝板  
可紅兩  
漏數頭  
脚生高

'Tis admired by all  
whom we meet,  
You will find not a  
crack in my boat,  
But you'll find under-  
neath it two feet:

## Whist Drive

At the first Whist Drive 16 years ago there were two tables now we have 10 tables in play which goes to show television hasn't taken over everybody's lives, it's nice to know that a good old game of Whist has not completely been wiped off. Sometimes a shout goes up that someone has scored the grand slam of thirteen tricks. These Whist Drives are always on the fourth Tuesday.

Mary Daniels

What is this old Chinese rhyme about?

Answer on page 8.

## Competition Corner

The February competition proved to be our most popular yet. All the entries received were correct and the first two names out of the boater were Frank Burling of Pembroke Court and Pauline Blackmore of Coles Road. Each will receive a prize which on this occasion were generously presented by **Milton's taxi service - Milton Cars.**

The answers to the puzzle were:

- |                  |                  |
|------------------|------------------|
| 1 Owl            | 6 Fulmar         |
| 2 Tern (and Emu) | 7 Swan (and Pen) |
| 3 Wren           | 8 Eagle          |
| 4 Lark           | 9 Teal           |
| 5 Kite (and Hen) | 10 Heron         |

### April Competition

Since the competition last month was so popular, this new puzzle is the same again. As before each of the sentences has the name of a bird hidden in it. For example, if the sentence was 'mines a bitter, not a mild' you will see that BITTERN is 'hidden'. The letters are always in sequence. Now see if you can find the 10 birds in the following sentences.:

- People who can't afford to pay for goods outright often buy them on the "never never".
- Some of the greatest film stars were of another age. Greta Garbo, Ronald Coleman, Ingrid Bergman and Cary Grant to name but a few.
- People often say that money is the root of all evil, but it's the love of money which is really the root.
- Australia has some of the strangest animals in the world. Duck billed platypus, kangaroo, koala bear, echidna and dingo are some of them.
- If you are too easy going with children, they will often take advantage of it. A firmer line is often necessary.
- If the water is too cold when you want to have a dip perhaps you should put it off for another day.
- In the heat of a summers day, a great past time is idly relaxing in a hammock in the shade.
- Jonah was sucked in by a fish - a giant whale - and he managed to survive the ordeal, which was a miracle.
- The teaser in this issue of the Village View is quite simple really. All you have to do is watch the birdy.
- And I'm quite sure every puzzler will be able to spot all of the birds in these sentences.

Entries to Michael Spooner, 43a Old School Lane, Milton. by May 1st please.

The first two winners drawn out of the hat will receive a prize of £10 and £5 kindly donated by **Betty's Hair Fashions, Milton.**

AMBITIOUS  
**COMPUTER EXCHANGE**

NEW AND SECOND USER COMPUTER SYSTEMS AND  
PERIPHERALS SURPLUS AND LIQUIDATED STOCK AT  
BARGAIN PRICES

355 NEWMARKET ROAD CAMBRIDGE

TEL: 01223 500923

CAMBS.COMPUTER.EXCHANGE@DIAL.PIPEX.COM

## MILTON SCHOOL OF DANCE



Under the direction of

JUDITH HILL R.A.D., I.S.T.D., BB, S.B.

For further details telephone 01223 236851

Ballet . Tap . Jazz . Ballroom  
Latin American

DENNIS  
COUSINS

CARPENTER  
& JOINER



EXTENSIONS  
FITTED KITCHENS  
ALTERATIONS  
IMPROVEMENTS  
CUSTOM JOINERY

23 GODING WAY  
MILTON  
CAMBS CB4 6AH  
TEL: (01223) 560657



## Interested in Football?

- Too old to get the boots on?
- Perhaps never good enough to get into a team?
- New to the Village?
- Have some spare time on your hands?
- Ladies; Think you know as much about football as men?

Then why not come forward to help MILTON F.C. (est. over 50 years). Enthusiastic/dedicated people required to join existing committee to assist with administration duties, fund-raising, preparation of pitches and to give help on match days for next season. For details ring \*Club Secretary Fraser Confrey on 440938.

### Players

Seniors; New Players always welcome. We run 3 Saturday sides for all abilities (youths to veterans) and 1 Sunday side. For full details ring Club Manager Keith Marr on 369324.

Colts; We are re-forming a Colts section for next season - Boys aged U'10s, U'12s and U'16s. For details ring Colts Secretary Hilary Davies on 441310.

### Companies/Individuals

We are continually seeking sponsorship/donations to help the running of the Club. We are indebted to our 2 main sponsors this season FastFix Scaffolding and The Lion and Lamb Public House, Milton. Please contact the \*Secretary if you would like to help in this way.

## MY BOAT

Chinese Rhyme  
answer  
A duck

## Milton Village View

Would like to thank once again  
Eastern Electricity for their continued  
sponsorship and Cambridge Evening News for  
their continued support.

## Mobile Library

Did you know the Mobile Library visits Milton every week? It is free to join and there is no charge for the loan of books.

You can borrow novels and information books, large print books, children's board books, picture books, stories and information books. Young adult books, talking books for all ages and videos are also available, where some charges apply, but with some exemptions.

You can borrow up to 12 items. The loan period for books and talking books is 8 weeks, 2 weeks for Videos.

If you wish to join the Library, you must take 2 documents - one for proof of your name and address, and a second, giving proof of your signature, e.g. driving licence, or bank card. If under 18 the signature of an adult resident in Milton is required as guarantor.

The Library stops at the Post Office on the 1st and 3rd Thursdays in the month at 9.15 am to 9.45 am and the High Street by the shops at 9.50 am to 10.15 am.

On the 2nd and 4th Thursdays it stops in the car park at the Community Centre at 2.45 pm until 4.00 pm.

Why go out of the Village to a Library when we have such an excellent amenity visiting Milton every week? So support it, so we can keep it.

Iris Chilton

## Milton Carpet Bowls Club FUN BOWLS EVENT 1997

Friday 30th May 7.30- 10pm  
Entry Form

Name of Club / Group / Pub \_\_\_\_\_

Captain \_\_\_\_\_ Player 2 \_\_\_\_\_

Player 3 \_\_\_\_\_ Player 4 \_\_\_\_\_

Name of charity or group to benefit if we win \_\_\_\_\_

Contact Address \_\_\_\_\_ Tel. No. \_\_\_\_\_

### RULES

1. Enter teams of four (no more than two members of any bowls club).
2. Entry is free but could each team provide a raffle prize please.
3. Winners receive half of any profits of the evening to donate to their nominated club / group or charity.

Please return this form to Jane Coston, 67 Coles Rd. by 20th May 1997 or Tel. 861655

## Milton Cricket Club

welcomes

New Members to play during  
**SUMMER 1997**

Regular and occasional players of all standards will find a team to suit them.

The club runs:

- 1st XI CCA Senior League Div. 1
- 2nd XI CCA Junior League Div. 3 (North)
- 3rd XI CCA Junior League Div. 6 (North)
- Sunday Friendly Team to promote and encourage youth players

Call Chris Almond 440715

### Colts Cricket

Under 11CCA Colts league

Under 13 "

Under 15 "

Call Maurice Claydon-Wallace 321944

## BENET GARAGE

### M.O.T TEST CENTRE

All Repairs and Servicing to any  
make of vehicle

Tel. 420380

### Lubricare 2 Lubrication Service

Oil & Filter change  
All Fluid levels topped up  
Plus

"Health Check" and written report.

**£38.95 + VAT**

Price inclusive of parts & labour

### lubricare 1 £16.95 + VAT

Engine Oil & Filter Change  
(price includes labour)

Full Air Conditioning service  
available

Calor Gas & Lucas Electrical  
Stockists

Paraffin & Diesel

Thanks to all our customers for  
their continued SUPPORT

## BOSCH

Service Agent for Cambridge  
For Fuel Injection and  
Electronic Ignition Service

### Lubricare 3 Major Service Lubricare 2 - "Plus"

Engine tune up; New spark plugs;  
New contact points; timing; OHV  
Tappets; Carburettor Adjustments;  
New air filter & Road Test.

**£69.95 + VAT**

Price inclusive of parts & labour

Printed by Cambridge Evening News, Winship Road, Milton, Cambridge, CB4 6PP

Produced and delivered by volunteers. Designed and published by Jane Coston, 67 Coles Road Milton Tel 861655

Editors - Michael Spooner, Iris Chilton, Kate Marshall, Harry Capitain

8 | If you use our advertisers, please mention the Village View. Thank you to our volunteer distributors.