



# Village News Sheet

Delivered Free  
Circulation 1,800

What's on	page 3
Millennium Ideas	page 4
New competition	page 7
Rowing Lake	page 8

**Spring Issue - April 1998**

**Issue 32**

## Double Celebration Year for Milton Primary



Chairman of Governors with the teachers and head of Milton Primary

Left to right - Helen Bett, Sandra Lee, Leslie Birch, Susan Roney, Jane Renwick, Chairman of Governors - John Harradine, Barry Moss, Headteacher - Tom Gillmore, Tara Fox, Amanda Cashmore, Ruth Bowers, Susan Dingwall, Val Gray, Maria Wilkinson, Paul Slater, Jill Dunkow, Jo Pierce, Rachel Grguric

Milton Primary School in Butt Lane will now be able to celebrate not only forty years but a great fortieth year as the school is presented with an excellent OFSTED report. In that report the Office for Standards in Education (OFSTED) praised headteacher Tom Gillmore, his staff and the governing body, as well as the quality of teaching and the behaviour of pupils. "Milton Primary School is a very good school with many positive features and some significant strengths," said the inspectors' report. They highlighted pupils' behaviour in and around the school as "exemplary" and added that the quality of pupils' personal development was excellent. By the end of Key Stage 2, the pupils' attainment is well above national expectations in English, mathematics and science.

Inspectors described the governors as a well informed body with a thorough understanding of their responsibilities. "They conduct themselves efficiently and are rigorous in their approach."

Chairman of Governors John Harradine said "I am delighted that the Report has confirmed our view that the school provides our children with such a good education.

I would particularly like to thank the Headteacher and all his staff for their hard work and commitment over many years."

JC

## Milton Pram Race

Having being long overdue for a comeback the Great Milton Pram race is back. This event has been scheduled for Easter Bank Holiday Monday (April 13th) - race starts 13:00pm.

The event will be in aid of the Milton Hospice. The last time this event was held in 1991 over £1000.00 was raised. This time we hope to double that figure.

So what's it all about? Well, all you have to do is build a pram in any design you wish. Prizes will be awarded to the best pram design and for the first pram across the finish line. The route will encompass visiting all 4 village pubs where each entrant has to down 1/2 a pint of beer! The event will be reported by Q103.

**How do I enter?** - Entry forms can be obtained from Dillons newsagents, or from any of the village pubs. Posters have been placed around the village.

**Rules** - Rules pertaining to the pram race are detailed on the back of the entry form. There will be a £5.00 entry fee per pram. Completed entry forms to be sent to Ian Jones, 11 Fen Rd, Milton, Cambridge, CB4 6AD

**Contacts:** - Any queries please contact Ian on 440031 or Rus on 504221. So dig out your old prams, GoKarts & wheel barrows and get building those speed machines. Best of luck and may the most devious Dick Dastardly win!!

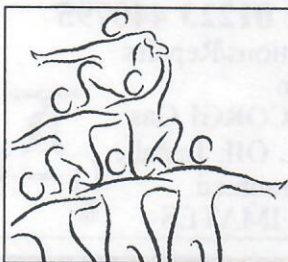

## Powerful friends in the community



Eastern Group includes Eastern Electricity, Eastern Generation, Eastern Natural Gas, Eastern Power & Energy Trading and Eastern Electricity Contracting



## Next Issue

due out beginning  
of June

Items for inclusion in  
the Summer Issue  
should be with one of  
the Editors by the  
**12th of May**

## Thanks

The Editors wish to thank Jim Fisher for all his help delivering Milton Village View to part of the Rowans during the past eight years and at the same time wish to welcome Mrs. Gibbons on to the delivery team.

May we also take this opportunity to thank all our delivery people once again for their tireless help, without which it would be impossible to bring this magazine to your doorsteps.

## Milton History

We are at the moment collecting information together to make a historic file of Milton to use in future issues of Milton Village View. If you have anything of interest that we could copy we would be very grateful.

## Gardening Service

Resident volunteers of Edmund House Group of Homes will be resuming the gardening service on the 1st of April. The scheme is open to Milton residents who are no longer able to maintain their own gardens due to age or infirmity. It is hoped the gardening volunteers will also have the opportunity to have use of a glasshouse based at Impington Village College. Our intention is to start a small nursery to raise plants to sell, this project is for the longer term. The costs of setting up for this project are high, we therefore are appealing for second hand tools, plants, plant pots and trays. If you can help us with these items or want to know more about the gardening volunteer service contact Carolyn Watts or Ian May at Edmund House on C 440186

## Say it with Flowers

Apparently the daffodils on the side of Milton Land fill site spell out some words and these can be seen from the top of a double decker bus. Do you know what they spell?

It has so far been an unusually warm year and this prompted the daffodils along side Bene't Close to burst into flower over Valentines weekend! Most of the daffodils planted alongside the verges have been purchased by the Parish Council and planted by volunteers. The last planting was done at the Humphries Way / Landbeach Road entrance and these have looked especially pleasing this year. It is hoped that more daffodils can be planted this autumn, if you would like to help or suggest an area to be planted please contact me.

Jane Coston Tel. 861655

## South Cambridgeshires Baha'is Multicultural Event



A group of delightful young Indian dancers stole the show at the Multicultural Event organised by The South Cambridgeshire Baha'i Community at Milton Community Centre last Saturday. This event coincided with a special time for Baha'i International community, as they celebrated the approach of their New Year on March 21.

These events are held in different parts of the region to bring together people of all races and backgrounds to celebrate their cultural diversity through an evening of entertainment and food. Participants are encouraged to bring a dish from their country of origin to share with others.

Other performances include folk music, Flamenco dancing renditions of songs from shows and a Viking drama all of which were greatly enjoyed by an audience of over 100 people. The event finished with a lively disco of music from around the world.

For further information contact:

Virginia Barnes Tel. 01763 838309,  
or Bernard Hoskin on 01223 834731



## PAINTING DECORATING GLAZING

Mobile  
0860 453533  
Fax:  
01223 863620  
(local resident)



**B.J. LEONARD**

## Schwarzkopf

For lasting curls  
style and volume with  
'Natural Styling'

at  
**Bettys Unisex Hairdressers**  
Tel: 420526

## FLORIES

### BRIDAL FLOWERS

Fresh, dried & silk bouquets etc.

Let me design your wedding personally

Fully qualified florist for 26 years

Phone Daryl 862093 or 01353 688303

## M J POTTS HEATING & PLUMBING SERVICES

300 The Rowans  
Tel: 01223 440795

All Installations/Repairs  
undertaken

Approved CORGI Gas  
& TOTAL OIL Install

Work Guaranteed

FREE ESTIMATES





MILTON OUTDOOR BOWLS CLUB

## JUMBLE SALE

Milton Outdoor Bowls Club  
Pavilion

**Saturday 18th April at  
2.30 p.m.**

Admission 20p

Thank you for your support

Date for Your Diary

## Milton Village Fayre Weekend

Family Disco

**Saturday 11th July**

Accompanied children free -  
16 and over £1 only

Village Fayre

Theme 'The Wild West'

**Sunday 12th July**

## Milton Parish Council Annual Parish Meeting

**Monday 28th April  
8.00p.m.**

Milton Community Centre

## The London Marathon

**Sponsor Peter Welton in the  
London Marathon**

**26th April**

**on behalf of the**

**Milton School Association.**

**If any local business would like  
to help by sponsoring the event  
or displaying posters and  
sponsorship forms on our behalf,  
please would they contact:**

**Claire Vickery  
on (01223) 860900.**

Thank you.

Milton School Association

A Registered Charity.

## Internet Evening

**Thursday 14th May  
7.30 p.m. - 9.00p.m**

Come and see a demonstration of what  
children are now able to do with  
computers in school.

See also how the the rest of the world  
sees Milton and Milton sees the world!

There will also be time for questions

Free Event

Milton Primary School

For more information contact:

Jane Coston Tel. 861655

## The Children's Hospice for the Eastern Region

**Saturday 16th May 1998**

**11.00a.m. - 4.00p.m.**

## Wild West Gala Day

at the Childrens Hospice for the Eastern  
Region, Church Lane, Milton

Free entry and free car park

Attractions will include Cowboys Shoot  
Outs and Indian Teepees, Tractor Rides,  
Bouncy Castle, Postman Pat and his van,  
Face Painting, Bric a brac, Refreshments,  
Cakes, Plants.

Guided Tours around the Hospice will  
be offered throughout the day

For more information call 01223  
441221

## MILTON COUNTRY PARK

### APRIL

**Saturday 4th April**

Sponsored Dog Walk - start 9 - 11a.m.

**Saturday 4th April**

WATCH - Discover Trees 2 - 3.30p.m.

**Sunday 12th April**

Easter Egg Hunt - 2.30p.m.

**Saturday 25th April**

Evening Bird Walk 6.30p.m.

£1.50 - Booking essential by 19th April

**Sunday 26th April**

Work Party - Spring Clean 9 -12 noon

### MAY

**Saturday 2nd May**

WATCH - Sensational Plants 2 -3.30p.m.

**Sunday 3rd May**

Dawn Chorus - 5a.m. - breakfast at  
7.30a.m. £5.50 Booking by 26th April

**Sunday 24th May**

Work Party - Nursery 9 -12 noon

All events/activities start  
from the Visitor Centre.  
Please wear suitable clothing.

A charge is made for the  
children's WATCH activities.

For further information  
contact:- The Ranger -  
Malcolm Busby on

(01223) 420060

## Tots in the Park

**Wednesday 8th April**

**10.00a.m. - 12.00 noon**

Activities for under - 5's  
with the Ranger

Malcolm Busby at  
Milton Country Park  
50p includes  
refreshments

Contact Hazel Smith

Tel. 860752

by Mon 6th April.

Royal British Legion (Waterbeach) and  
Royal Air Force Association (Milton)

**Saturday 30th May**

## Springtime Dance & Buffet

Waterbeach Primary School

**8.00p.m. to 11.30p.m.**

**Dancing to Billy Wright**

Tickets £7.00 including Buffet

Contact: 01223-514030



**Violin  
and  
Piano  
Tuition**

Please contact:  
**Fiona O'Shea, B.Ed Hons**  
**Tel. 440548 (Local resident)**



## MILTON GAS SERVICES

**Eddie Kikas**

29 Landbeach Road, Milton  
Tel/Fax: (01223) 861810  
Mobile: 0831 228181

 Corgi Registration  
Number 161938

Servicing, Installation & Repairs to  
all Gas Boilers, Fires, Cookers,  
Central Heating Systems etc.

**Nigel GODDEN  
AUTO SERVICES**

**All makes - service and repairs**  
**CITROEN AND TOYOTA SPECIALIST**

SERVICING, CAMBELTS REPIPING,  
CLUTCHES, NEW CHASSIS, BRAKE  
OVERHAUL, WELDING, ELECTRICAL  
FAULTS, ABS, INJECTION SYSTEMS ETC.  
CALL NOW FOR FRIENDLY ADVICE OR QUOTE

UNIT 13 CAVE IND ESTATE  
FEN ROAD  
CHESTERTON  
CAMBRIDGE

TEL: 01223 425125 MOBILE: 0831 817981  
**MILTON RESIDENT**



MILTON VILLAGE FAYRE MILTON VILLAGE FAYRE MILTON VILLAGE FAYRE

Sunday 12th July 1998

12.30pm - 5.00pm.

This year's theme is "The Wild West"

Please return this Booking form to Sue Nunn, 75 Coles Road, Milton, Cambridge. **By 28th June.**

**£5 per pitch. Cheques payable to Milton Village Fayre.**

Please book the following on behalf of .....

Number of stalls required @ 3.6m wide .....

Type of stall/activity, whatever? .....

Tent/Caravan to be used [state which] .....

Do you require a trestle table? YES/NO ..... [You are requested to provide your own chairs]

Any special requirements? i.e. electricity .....

Signed ..... Please print name .....

Address .....

Tel. No. .... Amount enclosed £ .....

Name & Tel. No. OF VOLUNTEER FOR CLEARING GROUND AFTER

FAYRE

## Ideas for Celebrating the Millennium

The Millennium Committee had its first meeting on March 17th at Milton Community Centre. A number of ideas were put forward and it was agreed to list them in the Village View for your comments. Some projects would cost virtually nothing whilst others will have to find funding.

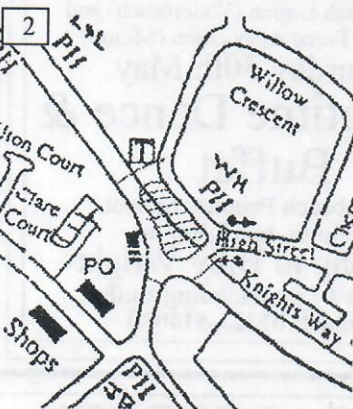
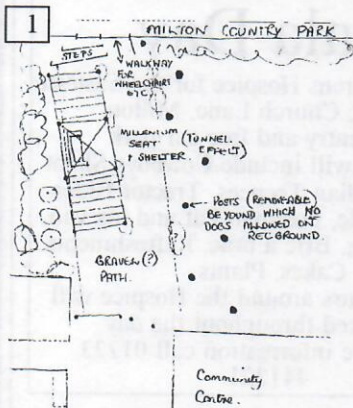

1 A path and walk way between the Country Park and Milton Community Centre. Suggested by Lynne Twinn with a similar suggestion for a path from Ian Davis.

2 Creating a Millennium Green in the centre of the village by making roads in the area narrower. Suggested by Revd. Ian Cowley

3 Millennium Maze, created using mounded earth as Hilton Maze - possibly sited on the green or a play area. Suggested by Jane Coston

4 Sensory Garden to be situated between the Doctors surgery car park and the Community Centre garage, with a link into Tomkins Mead Nature Reserve. Suggested by Don Wildman.

5 Creating a learning centre to encourage creativity for all ages. Suggested by David Lee

6 A fully equipped Information Technology Room to be used as a library and meeting room. Suggested by Jane Coston.

7 A suggestion that people take seed from a favourite tree that means something to them and to grow them into trees for planting possibly in a Millennium Wood. Suggested by Jo Snaith.

8 Build a purpose built youth centre with coffee bar. Suggested by Hazel Smith

Space has not allowed us to give justice to the above ideas which were explained in detail at the meeting and were felt to be worth further investigation.

Please send your comments to:  
67 Coles Road, Milton.

Eric Pranklin trading as

**Pete's Quality Meats**

1a Arbury Road, Cambridge  
Tel. 01223 352853

Suppliers of first class pork, lamb, beef, poultry and game

**HIGH WELFARE AND FREE RANGE PRODUCTS A SPECIALITY**

**FREE** delivery in Milton  
Hand made sausages and burgers

B-B-Q packs, freezer packs, mixed grills made to order

**SPECIAL OFFERS AVAILABLE**  
Tel: Eric 01223 352853

## The Friends of Milton Country Park

Spring has sprung!!! The week beginning February 14th, the day it is said that birds mate for the coming year, saw the 'Friends' inviting people to come to the Park to make nest boxes. In all forty three boxes were made during the week, a few of which were donated for siting in the Park. A big thank you on behalf of the birds, to all those who took part.

Early Monday 9th February, Radio Cambridgeshire joined us in the Park. A short live interview took place in Tomkins Mead. The 'Friends' and Park Rangers, with the co-operation of the Parish Council and finance from East Waste Ltd., through Eventure Southern, celebrated the hard work that has been done there, and later the same day a bridge was placed over the ditch. Now there is access to Tomkins Mead for everyone, and hopefully the management in the area will encourage growth of many wild flowers which were previously abundant there.

Tim Siggs Chairman

## MILTON POST OFFICE

CARDS SHOE REPAIRS  
CONFECTIONARY PHOTO COPYING  
DRY CLEANING FAX SERVICE  
STATIONERY GIFTS

2 COLES ROAD MILTON

Open: Mon - Fri 9.00am. to 5.30pm.  
Saturday 9.00am. to 1.00pm.

**Painter & Decorator**  
**Interior & Exterior**  
**High Class Decorating**  
**Free Estimates**

**R.P. Kent**

Tel. 01223

**860995**



**MILTON WINDOWS**

**Quality costs no more**

PVCu windows, doors, cladding & conservatories

Telephone 01223 440376



## School Memories of Milton Past



The Old School in Fen Road, Milton

### School Days in Milton

The lessons I liked best were spelling, writing and what was called dictation, and anything to do with figures. Geography and history were not my best subjects, but one history exam I felt quite confident that I would get good marks. Well, I would have done had I not let someone sitting next to me copy my paper, she thought by altering a few words the master wouldn't notice, (what a silly girl I was!). Well she wouldn't own up and I was a bit scared what she would do to me so we just kept quiet. Result; my 80 out of 100 was reduced to 40. Funny how these things stick in ones mind.

Mary Burling - That Was.

### Old School School Photograph

In the last issue of Milton Village View we asked if anyone could put names to faces. The photo was taken Summer 1958 just before the school closed. Olive Parker (89) who was 10 when she went to Milton Primary, has sent us some of the names she can remember:-

Anne Carter, Rosemary Carter, Anne Thoday, Jennifer Carlton, Hazel Grey, Susan Hall, Winifred Ashman, Boy Froment & Shipp, Margaret Wilkin.

Jim Daniels has very kindly given us the following list. Those marked \* still live in the village. Those marked \*\* live in Milton after having moved away for many years. We have put in a question mark where a name is unknown. Can you help with the faces we still have no names for?

Back Row: Mrs Wooding, Rupert Webb, Stuart Carlton, Denise Palmer, Susan Halls, William Rippingale, Jim Daniels, Miss Sutcliffe (Headteacher) Nora Halls

3rd Row: Linda Allen, ?, ?, ? Archibald, Christopher North, ?, ?, Michael Tyrrell, Jennifer Carlton, ?, ?, Hazel Gray

2nd Row: ?, Nigel Waterson, ?North, ?, Rosemary Carter?, Raymond Gray, John Allen\*, ?Froment, ?, ?, Philip Adams, Ann Carter?, ? Archibald

Front Row: Timothy Siggs\*\*, Roy Gray, Alistair Archibald, ? Worsley, Dennis Allen, Ian Warner, Angela Whittington/Worthington, Margaret Constable, Christine Easy\*, Margaret Wilkin, Sonia Gray, ?, Christine Hall

### Milton Primary School 1998

Milton Primary extensions have just been completed. The letter below is to the architect from one of the children at the school.

Dear Mr Hickford,

Hi my name is Emma Fordham and I am ten years old. I am writing to tell you of what I think of the new building. I think that it's really nice the way you designed the extension I personally think the best part is the annexe because of the fountain and the way the benches go round it. It is also really cool how the windows are pointed at the top and as there so much bigger we have more light. Talking about lights, I love the circular ones in the hall, they give the building a really good effect!

I am really pleased that we have got central heating because when we were in the mobile we had a gas heater which we had to keep turning off and on and opening the windows when it got quite hot.

The white board has squares on it which helps Miss Cashmore a lot because her writing was going up or down in a slope. It also slides which is helpful because Miss Cashmore only had one block so it wasn't very helpful!

Yours sincerely  
Emma Fordham

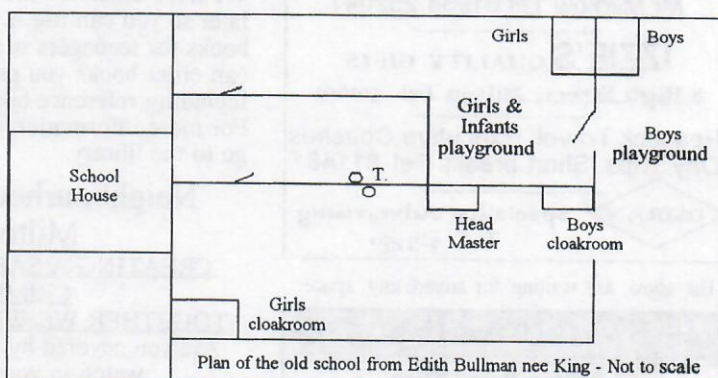

### Parish Council Minutes of the Past

30 Years Ago - 22nd March 1968

It was reported that the number of pupils attending school now 164. 140 stay to mid day meal; there were now 3 junior and 3 infant classrooms, 6 full-time staff and 1 part time.

45 Years Ago - 25th March 1953

The Rev. J Plumley reported that the school will now be maintained by the Local Education Committee and would be known as the Milton Parochial Church of England Voluntary Controlled School.

**M.J. BLACK**

Carpentry & Joinery  
Fitted Kitchen Specialists  
complete service from  
Planning to Installation

Tel. (01223) 277772

Mobile 0831 626398

**R B**

Electrical

Your Milton  
Domestic and  
Industrial Specialists

Tel. 365200

+++++

**Karen's Hair Studio**

1a Coles Road, Milton

Wednesdays

- Senior Citizens Day - 20% reduction

**Opening hours**

Tuesday 9am-5.30 (Closed Mondays)

Wednesday / Thursday 9am-6.00

Friday 9am-7.00 Saturday 9am-5.00

**Tel: (01223) 440198**

**Easy Parking**

+++++



## GUEST ADVERTISER

### KATHY PLATT

Dip.(Adl) Counselling

### QUALIFIED COUNSELLOR

dealing with  
depression, stress, bereavement, personal  
and relationship problems.

For more information about how counselling  
could help you or to make an appointment,  
please contact me on:-

01223 861510

MILTON

### Local Music Teacher

David Verge Tel. 01223 862077

### Music Lessons

Alistair Lyle Tel. 01223 321915

### BRICKLAYING/BUILDING CONTRACTORS

FOSTER & CARBIS Tel. 863275

### PAINTER & DECORATOR

DAVID PECK Tel: 01954 211428

### Garden Maintenance

Mr Medlow Tel 01954 252047

### IZZIE'S QUALITY GIFTS

8 High Street, Milton Tel. 501601

Peacock Travel, Executive Coaches  
Day Trips, Short breaks Tel. 811481

OSIRAN

Speciality Advertising  
Tel. 425750

The above are waiting for advertising space.

## VACANCIES

### Milton Post Office

Part time post office/shop assistant  
required to work afternoons only.  
Hours are 2.00 - 5.30p.m. and full  
time in the school holidays. If  
interested please ring: 860231

**Cleaner** required for 10 hours weekly  
after school during term time from:

4pm to 6pm or 3.30 - 5.30pm  
£4 per hour

Please phone the headteacher of  
**Milton Primary School**  
Telephone: 01223 - 508783

### Lizzie's Workout

Milton Primary School

Monday 6.45 pm - 7.30 pm BodyBlitz, Thighs, Bums & Tums  
7.30 pm - 8.30 pm Step Class  
Wednesday 7.30 pm - 8.30 pm Fat Burning Step

Tel. Liz Ward (01638) 721318

## MASQUERADE

Hair & Beauty Salon

6 High Street, Milton, Cambs.

Tel. (01223) 863636

For all hair & beauty treatments

## All Saints Church

### Maundy Thursday

11.30a.m. Holy Communion  
8.00p.m. Holy Communion

### Good Friday

1.00p.m. Prayer Walk around Milton  
2 - 3.00p.m. Hour at the cross  
7.00p.m. Family service

### Easter Sunday

"The Resurrection of Christ"

8.00a.m. Holy Communion 1662  
10.30a.m. Holy Communion ASB  
6.30p.m. Evening Prayer 1662 (said)  
8.15p.m. City Praise with Holy Communion at Holy Trinity, Cambridge

Alpha

Alpha Supper

Alpha course

A 10 week introductory course to Christianity

Sat. 4th April - an informal opportunity to find out more.

held on Thursday evenings from 23rd April to 9th July.

Leaflets with more details at the back of the church.

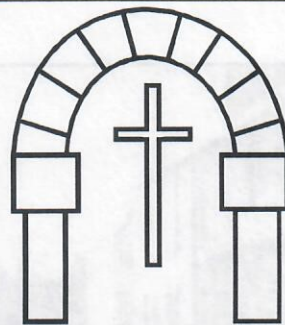

## Connections Youth Bus

visits the Sycamores Rec.

Thursdays 7.15 - 9.30

for 14 years upwards

## Mobile Library Service

Starting 1st April

(Alternate Wednesdays)

Milton Post Office 9.30 - 10.10

Milton High Street 10.15 - 10.30

Community Centre 2.00 - 4.30

## Secondary School Students -

We have asked for the Library to stay  
later so you can use it. A range of  
books for teenagers is available and you  
can order books you particularly want,  
including reference books.

For more information phone 718362 or  
go to the library.

## Neighbourhood Watch

Milton

CREATING A SAFER MILTON

CRIME

TOGETHER WE WILL CRACK IT

Are you covered by neighbourhood  
watch in your street?

Have you been a victim of crime?

Did you know that crime in Milton has  
reduced since 1995?

Are you interested in keeping that  
trend going?

If you want to help or simply wish to  
get the answers to the above questions  
then contact either:-

Police Constable Phil Shulver or  
special Constable Fred Lawes on 01223  
823251 at Histon Police Station or  
Jim Daniels - Clerk to Milton Parish  
Council on 01223 861447

## Junior Youth Club

Year 6 to 14 year old.

Milton Community Centre

Thursdays 7 - 9 p.m., term time.

Exciting programme of activities  
always on offer.

Last term we had:

Caribbean steel drumming

Visit to Laserquest

Outdoor activities

## Notice

Milton Village View is unable to check or verify  
the warranties, authenticity of or representations  
made by their advertisers and must therefore  
exclude liability howsoever arising from any  
advertisements in this newspaper. Nor do any  
statements necessarily accord with the opinions  
or beliefs of the Editors, Milton Parish Council  
or Milton Village View.

## ALMOND INDEPENDENT

INDEPENDENT FINANCIAL ADVISORS

Chris Almond

MLIA(dip)

FINANCIAL ADVISOR

A MEMBER OF DBS FINANCIAL MANAGEMENT PLC

Tel. 01223 440715 FAX. 01223 502510



MONDAYS

7.00 - 8.00 pm

LEGS, BUMS & TUMS

Main Hall

Milton Community Centre

NEW! WEDNESDAYS

7.00 - 8.00 pm

Hi/Lo AEROBICS

Milton Road Junior School

Gilbert Road, Cambridge

Commences:

14 January 1998

£2.50 per class

Please bring an exercise mat/towel with you

Julie Durrant : 01223 441036

RSAYMCA Qualified Instructor

Member of the Exercise Association

## Clean Quality Workmanship from Planning to Completion.

FREE ESTIMATES & ADVICE



BUILDING  
CONTRACTOR

86 Butt Lane  
Milton

- New Houses
- Extensions
- Renovations
- Conservatories
- Loft Conversions
- UPVC Windows & Doors

TELEPHONE: 01223 440126

## HOWARDS WAY

DOT.ADL\CAADI.DIA.

- \* Excellent Pass Rate
- \* Top Grade Instructor
- \* Free Lesson / Discounts
- \* Refresher Courses
- \* Motorway / Dual  
Carriageway Tuition

Tel. (01223) 862501

(0589) 218045

193 The Rowans, Milton, Cambridge.



## Puzzle Corner

Lots of entries for the 'Notable Events of this Century' competition which appeared in the last issue. The first two names to be drawn out of the hat were Mrs B Cawthorne of Wilson Way and Mrs P Scurl of The Rowans. Congratulations to both who will be receiving prizes which were generously donated by **B J Leonard, Painters and Decorators of Milton**

The answers were:

- 1 1912 Sinking of the Titanic
- 2 1924 First Labour Government in Great Britain
- 3 1936 King Edward Abdicates
- 4 1947 Princess Elizabeth Marries
- 5 1948 Nationalisation of the Railways
- 6 1953 Hilary and Tensing Climb Everest
- 7 1954 Roger Bannister Runs the First Four Minute Mile
- 8 1966 England Win the World Cup
- 9 1969 First Man on the Moon
- 10 1983 Derby Winner Shergar Stolen

The puzzle this month should present no problems, here are eight well known proverbs which are 'in disguise'. What are they?

- 1 Lots of bunches of bananas fashion a window opus
- 2 A surplus of culinary experts over indulge the minestone
- 3 The pack of lions precedes a yield to temptation
- 4 A stomach cramp between 6 o'clock and 7 o'clock stores up the muses
- 5 View in front of spring
- 6 Peaceful drinks race the sea
- 7 An hour and the ebb delay not a soul
- 8 The lion in oz the blonde

**M J Potts Heating & Plumbing Services** have generously donated a £10 and a £5 prize for the first two correct entries.

Please send your entries by the 1st of May to: Michael Spooner, 43a Old School Lane, Milton, Cambridge CB4 6BS.

## We're not buying it information

We hope to deliver to you inside this magazine, the Cambridgeshire Constabulary "We're not buying it" information and stickers. This will probably be done a few streets at a time over the next few months to allow us to collate this it into the magazine before delivery. We hope you find this information helpful.

## Womens Institute

March meeting is our AGM when we elect a new committee. We would welcome new committee members. We are all happy as we are but new faces have new ideas, and believe you me the committee meetings are very happy ones. We enjoyed a salt dough demonstration in February. It was most interesting with some fascinating ideas for ornaments, wall hangings etc.. Later this year some of us will be visiting Denman College in Oxford.

Mary Daniels

## 'What's In The Name Of A Road?' No.1

In Milton as in many other villages and towns, the main road is the High Street with other roads appropriately named leading to neighbouring built up areas i.e. Cambridge, Ely and Landbeach; Fen Road (originally Lane) and Church Lane connect with obvious places. The name of the remaining old road in Milton, Butt Lane is shrouded in history. This road over 200 years ago led only to the Roman road (Mere Way or Akeman Street) which runs North from Cambridge along the Western boundary of Milton parish and across the Fens towards Ely. Butt lane literally 'butted' on to the Mere Way and only after around 1800 did it continue to Impington; during the time of the Romans, Butt Lane may well have connected the Mere Way with the River Cam via Fen Road for the transport of goods.

In future editions of the news sheet, I will be reviewing names given to the more modern roads in the village. Many of these will be obvious to the 'older' inhabitants, but perhaps less so to our 'new arrivals'. As a foretaste of things to come, Fox's Close off Butt Lane - did a wily creature evade the huntsman in this part of the village, or was he a notable person living nearby?

All will be revealed in the next edition of the Village View!  
Derek Booth

## Who was Barnabas Shipp

At the Parish Council meeting on 2nd January we recommended that the new sheltered housing be named Barnabas Shipp Court. Why did we do this?

According to the Parish records Barnabas Shipp was at one time employed by the Parish as a "roadman" however his relevance to the sheltered housing comes after his retirement.

In 1961 a motion was passed by the Parish Council to write to Mr Shipp commending him for voluntarily sweeping and cleaning the bus shelter near the entrance to the sheltered housing. He was then aged 90!

Mr Shipp next comes to our attention in 1971 when he reached his centenary. The Parish Council congratulated him and voted to send him a case of wine. They also proposed to name the second phase of Old School Lane, then about to be built, Shipp Lane but due to a change in the plans this never happened.

The Parish Council now propose to remedy this, recommending that the new development for our older residents be named after Barnabas Shipp.

Paul Oldham

## Poetry Circle

- Meets monthly in Milton
- No special knowledge required - just an enthusiasm for poetry and a wish to share it with others in a relaxed and informal atmosphere.
- For more details telephone Mary on Cambridge 860451

## Roller Blading

Roller Hockey  
Each Saturday at Cambridge Regional College, Kings Hedges Road. between 9.00a.m. and 2.00p.m. Activities are supervised and are indoors.

Contact Nigel Barker, Tel. no. 01954 211128.

Aggressive Rollerblading  
Activities take place at Impington Village College and include making equipment (i.e. ramps etc.) as well as rollerblading practice.

Contact Andy Allen

Tel. no. 200400

## VACUUM CLEANER SERVICE & REPAIR



**Brian Honey**  
44 Denny End Road  
Waterbeach  
Tel: 01223 861708  
evenings and week-ends

FREE ESTIMATES  
LOCAL COLLECTION

## MILTON SCHOOL OF DANCE



Under the direction of  
**JUDITH HILL** R.A.D., I.S.T.D., BB, S.B.

For further details telephone 01223 236851

**Ballet . Tap . Jazz . Ballroom  
Latin American**

## DENNIS COUSINS

**CARPENTER & JOINER**



**EXTENSIONS  
FITTED KITCHENS  
ALTERATIONS  
IMPROVEMENTS  
CUSTOM JOINERY**

**23 GODING WAY  
MILTON  
CAMBS CB4 6AH  
TEL: (01223) 560657**



## Cambridge Rowing lake - update 25.3.98

### Lottery application

The Trust submitted its application for Lottery funding for A Rowing Lake for Cambridge to the Sports Council in October '97. A Lottery decision is not expected until a National Rowing Strategy is completed for the ARA, the national governing body of rowing, in July '98. The cost estimate for the project is £13.93m. We have applied for 65% funding from the Lottery Sports Fund, leaving us with £4.88m to raise. Over £2m has been pledged to date.

The proposal is for a 200 acre country park including a 2000 metre eight lane course connected to the River Cam near Bates Bite Lock by a two lane canal and a 1000 metre four lane cut. The earliest possible date for filling the Rowing Lake is spring 2000. There will be free access for the public on foot or by bicycle. The cycle path which will go around the lake will be connected to the river towpath.

The plans include a boathouse with manager's flat, an indoor rowing/sculling tank, disabled accessible changing rooms and boats for junior and schools rowing, as well as basic provision for adult beginners. Juniors and complete beginners are two groups who might not benefit fully from the Lake if they had to row down from the existing boathouses to access it, as the vast majority of crews using the Lake will do.

### Ongoing rowing development in Cambridge

The Trust is working with the existing clubs to develop structures to recruit more people to rowing, particularly through links with schools. The Cambridge Rowing Trust Schools & Junior Rowing Group (with representatives from clubs, the ARA, Local Authorities and six local schools including Impington Village College) was set up for this purpose, new members from schools would be very welcome and should contact Rosemary Hoskins at the Trust.

A new working group on Veteran & Recreational Rowing is also meeting, with an initial focus on encouraging adult women beginners to take up the sport.

Cambridge Rowing Trust is a charitable Company limited by guarantee (registered number 2963773) and a registered Charity (number 1040693).

Cambridge Rowing Trust, PO Box 849, Waterbeach, Cambridge, CB5 9RT. Tel 01223 576360 Fax 01223 576359.

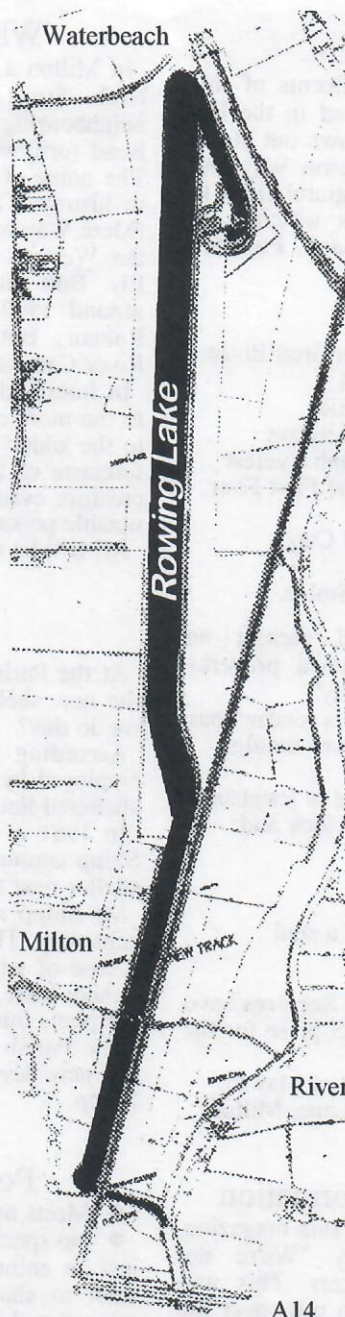

## Outdoor Bowls Club

### Open day

2p.m. Sunday 10th May  
1998

If you would like to try your hand at playing the game of bowls then come and join us at 2p.m. on Sunday, 10th May, 1998 at the Bowls green, Coles Road Recreation Ground, Milton.

We will supply the bowls and tuition, all you need is a pair of flat soled shoes, plimsolls or trainers.

At 4p.m. there will be light refreshments in the pavilion at no charge.

All persons are welcome, no restriction on your age or gender!

For more information, please contact:

Bob Waters  
on 01223 860620

## Join us for a game of Netball in the Summer League

Come to the village courts on a Tuesday evening 7.30 - 8.30 and join in our training. A good fun way to keep fit and if you are a little bit competitive you could join us for the Summer league, normally held on Thursday evenings for short friendly games of netball.

We have several new members and so you won't be alone in being new.

Interested? Then come along to the Floodlit courts on the Milton Recreation Ground this Tuesday or ring Charlotte Colleen on 01223 503741 who will be pleased to arrange to meet you up at the court.

## BENET GARAGE

### M.O.T TEST CENTRE

All Repairs and Servicing to any  
make of vehicle

Tel. 420380

### Lubricare 2 Lubrication Service

Oil & Filter change  
All Fluid levels topped up  
Plus

"Health Check" and written report.

**£38.95 + VAT**

Price inclusive of parts & labour

### lubricare 1 £16.95 + VAT

Engine Oil & Filter Change  
(price includes labour)

Full Air Conditioning service  
available

Calor Gas & Lucas Electrical  
Stockists

Paraffin & Diesel

Thanks to all our customers for  
their continued SUPPORT

## BOSCH

Service Agent for Cambridge  
For Fuel Injection and  
Electronic Ignition Service

### Lubricare 3 Major Service Lubricare 2 - "Plus"

Engine tune up; New spark plugs;  
New contact points; timing; OHV  
Tappets; Carburettor Adjustments;  
New air filter & Road Test.

**£69.95 + VAT**

Price inclusive of parts & labour

Printed by Cambridge Evening News, Winship Road, Milton, Cambridge, CB4 6PP  
Produced and delivered by volunteers. Designed and published by Jane Coston, 67 Coles Road Milton Tel. 861655  
Editors - Michael Spooner, Iris Chilton, Kate Marshall, Harry Captain

8 If you use our advertisers, please mention the Village View. Thank you to our volunteer distributors.

<http://www.the-hug.demon.co.uk/milton/> email: poldham@cix.co.uk